

PRODUCT NUMBER	PITCH
YExx01x100J0G	5.00 mm

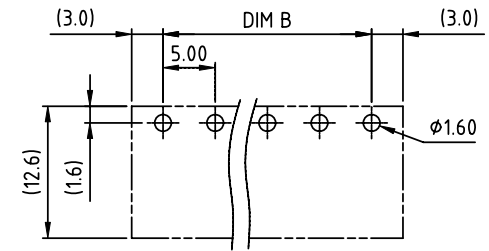

RECOMMENDED P.C.B LAYOUT
TOP VIEW

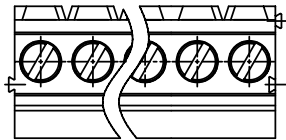
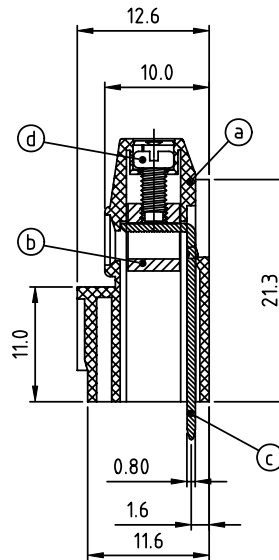
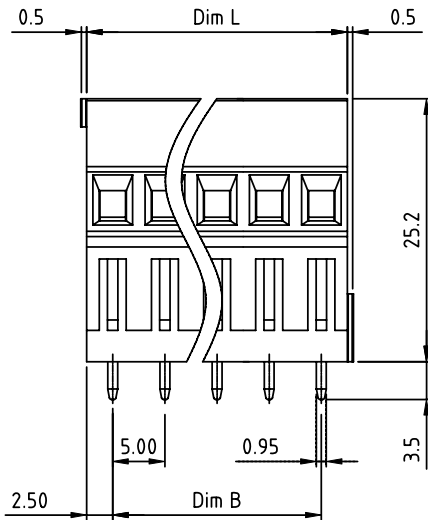

Material:

- Item ① Terminal housing: Thermoplastic (UL 94V-0)
- Item ② Clamp: Brass, Ni plated
- Item ③ Solder pin: Brass, Tin plated
- Item ④ Terminal screw: Steel, Zinc plating"-slot type

Electrical cULus

- Voltage rating: 300VAC
- Current rating: 10A
- Wire range:
- Solid wire(AWG): 12-24
- Stranded wire(AWG): 12-24
- Torque(Lb-In): 3.5
- Screw: M2.5
- Wire strip length: 6-7mm
- Withstanding Voltage: 1.6KV
- Operating temperature: -40°C to +115°C
- Soldering temperature: 260°C±5°C/5 Sec
- Safety Approval:

DIMENSION

Dim L	Nx5.0
Dim B	(N-1)x5.0

N=Number of poles

Poles	Tolerance
4p~6p	±0.15
7p~12p	±0.25
13p~18p	±0.35
19p~24p	±0.40

PART NO.: YE xx 0 1 x 1 00J0 G

Solid block	0	Color	2	RoHS compliant	(lead<4%)
No. of poles	2	Black (RAL9005)		In copper Alloy	
04 4 poles	3	Red (RAL3001/D)			
05 5 poles	4	Orange(RAL2011/P)			
...	5	Yellow(RAL1018/A)			
24 24 poles	6	Green(RAL6018/T)			
	7	Blue (RAL5015/A)			
	8	Grey(RAL7035/D)			
	9	White(RAL1102)			
	C	Green(RAL6018/U)			

mat'l. code		surface	tolerance	projection	product family
		ASME Y14.5	ASME Y14.5		TERMINAL BLOCK
ltr		tolerances unless otherwise specified		title	
ecn	no	dr	date	TERMINAL BLOCK	
				RISING CLAMP, 180D WIRE INLET,SOLID BLOCK	
				dwg no	
				sheet 1 of 1	
				size	
				A4	
				type	
				CUSTOMER Drawing	
sheet index	revision	A			
	sheet	1			