

REVISIONS					
REV	ECO	DESCRIPTION	DATE	BY	APPR
B1	-	RELEASE NEW DWG FORMAT	06/16/14	TOD	TOMMY
B2	-	UPDTAED SPECIFICATION	09/14/15	TOD	TOMMY

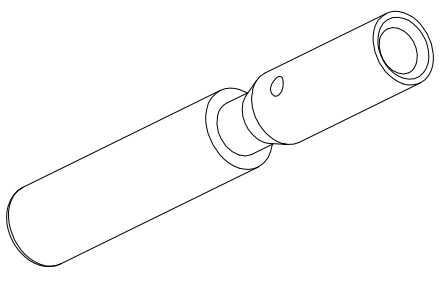
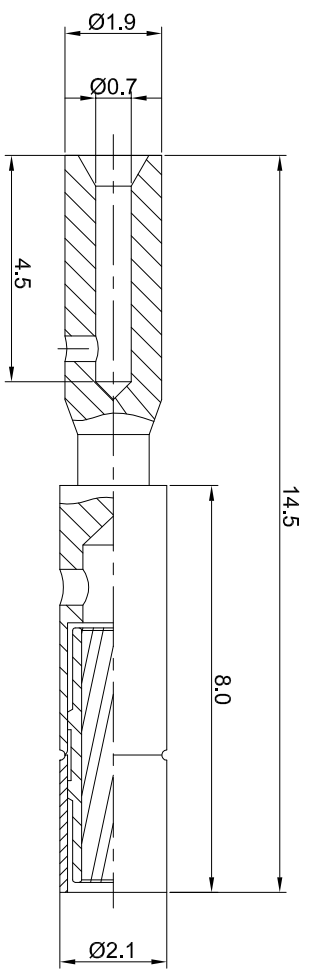

- NOTES: UNLESS OTHERWISE SPECIFIED
- MATERIAL: COPPER ALLOY, GOLD PLATED
  - SPECIFICATIONS:
    - 2.1 RATED CURRENT: 10 AMPS
    - 2.2 CONTACT RESISTANCE: <5 milliohm
    - 2.3 AVAILABLE WIRE RANGE: 28AWG~24AWG
    - 2.4 ROHS COMPLANT
  - ALL DIMENSIONS ARE FOR REFERENCE USE ONLY.

QUANTITY	SEE PART NUMBER CHART	PART NUMBER	DESCRIPTION	ITEM
<b>MATERIALS LIST</b>				
UNLESS OTHERWISE SPECIFIED 1) All dimensions are in millimeters. 2) Tolerances are as follows: 1 Pt. DEC 20.00 2 Pt. DEC 20.00 3 Pt. DEC 20.08 3) Note reference =		DRAWN: tod	DATE: 09/14/15	
MATERIAL SPECIFICATIONS:		CHECKED:	ENGINEER:	APPROVAL:
PROCESS SPECIFICATIONS:		CUSTOMER:	Socket contact, 20#, Chmp 28-24AWG	
NEXT ASSY:		THIS DRAWING IS SUPPLIED FOR INFORMATION ONLY. DESIGN FEATURES, SPECIFICATIONS AND PERFORMANCE DATA ARE SUBJECT TO CHANGE WITHOUT NOTICE. THE APPLICABLE SPECIFICATION NO RIGHTS OF REPRODUCTION ARE IMPLIED. ALL MANUFACTURING VARIATIONS.		
SCALE: NONE		SIZE: B TYPE: C- DWG NO: SC000030 REVISION: B2		

TITLE:	Socket contact, 20#, Chmp 28-24AWG
DWG NO:	SC000030
REV:	B2
SH:	1
OF:	1